

Plumbing Fixtures Pre-Rinse Units



908000-B

8" Wall & Deck Mount Pre-Rinse Units

- A 3-ply, 400 PSI test hose
- Integral spring check valves to prevent cross-flow of hot and cold water
- Standard with 44" hose
- Standard with 990033 Spray Head
- Optional style Spray Heads available
- 12" Wall Bracket supplied - cut to size for installation

8" Wall & Deck Mount Pre-Rinse Units		
Model No.	Description	Wt. lbs.
908000-B	8" Wall Mount Pre-Rinse Unit with 12" wall bracket attached and ½" NPT female inlets	12
901080-B	8" Deck Mount Pre-Rinse Unit with 12" wall bracket attached and ½" NPT female inlets	12
Approximate Height 45"		



901080-B



990031



990032



990033

Spray Valve Assembly		
Model No.	Description	Weight lbs.
990031	Pot filler spray valve assembly	2
990032	Angled spray valve assembly	2
990033	Pre-Rinse spray valve assembly, w/big bumper rubber ring & face plate	2

4" Deck Mount Pre-Rinse Units

- A 3-ply, 400 PSI test hose
- Integral spring check valves to prevent cross-flow of hot and cold water
- Standard with 44" hose
- Standard with 990033 Spray Head
- Optional style Spray Heads available
- 12" Wall Bracket supplied - cut to size for installation

4" Wall & Deck Mount Pre-Rinse Units		
Model No.	Description	Wt. lbs.
901000-B	4" Deck Mount Pre-Rinse Unit with 12" wall bracket attached and ½" NPT female inlets	12
901040-B	4" Deck Mount Pre-Rinse Unit with 12" wall bracket attached and ½" NPT female inlets	12
Approximate Height 45"		



901000-B



901040-B



990031



990032



990033

Spray Valve Assembly		
Model No.	Description	Weight lbs.
990031	Pot filler spray valve assembly	2
990032	Angled spray valve assembly	2
990033	Pre-Rinse spray valve assembly, w/big bumper rubber ring & face plate	2

Plumbing Fixtures Pre-Rinse Units



908010-B

Single Wall & Deck Mount Pre-Rinse Units

- A 3-ply, 400 PSI test hose
- Integral spring check valves to prevent cross-flow of hot and cold water
- Standard with 44" hose
- Standard with 990033 Spray Head
- Optional style Spray Heads available
- 12" Wall Bracket supplied - cut to size for installation



901010-D

Single Mount Pre-Rinse Units		
Model No.	Description	Wt. lbs.
908010-B	Single Wall Mount Pre-Rinse Unit with 12" wall bracket attached and 1/2" NPT MALE inlet	12
901010-D	Single Deck Mount Pre-Rinse Unit with 12" wall bracket attached and Universal 1/4" NPT or 1/2" NPS inlet	12
Approximate Height 45"		



990031



990032



990033

Spray Valve Assembly		
Model No.	Description	Weight lbs.
990031	Pot filler spray valve assembly	2
990032	Angled spray valve assembly	2
990033	Pre-Rinse spray valve assembly, w/big bumper rubber ring & face plate	2

Pre-Rinse Parts

PRERINSE UNITS Feature:

- Quality engineering, design and craftsmanship
- Heavy Duty brass and forged brass body construction
- Chrome polished finish

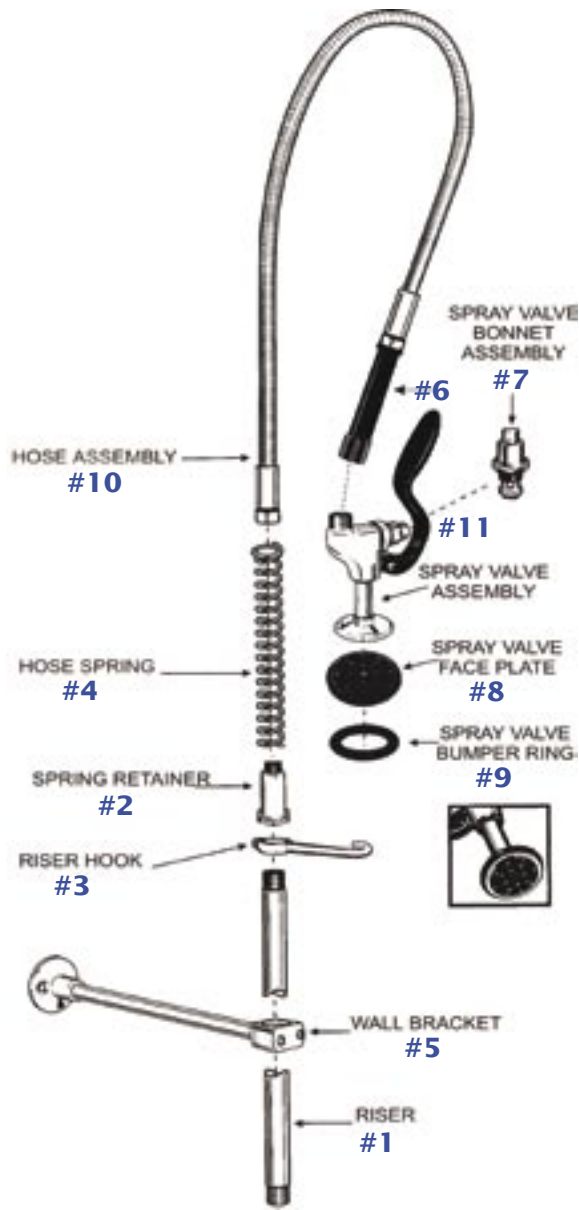

HOSE Features:

- 3-Ply, 400 PSI Test Hose
- 210° F/99° C rated
- Stainless steel outer jacket
- Stainless steel collars for added durability

	Model No.	Description
#1	909001	24" Riser
#2	909002	Spring Retainer
#3	909003	Riser Hook
#4	909004	Hose Spring
#5	909005	12" Wall Bracket
#6	909006	Hose Grip
#7	909007	Spray Valve Bonnet Assembly
#8	909008P	Plastic Spray Valve Face Plate
	909008	Brass Spray Valve Face Plate
#9	909009S	Small-Spray Valve Bumper Ring
	909009B	Big-Spray Valve Bumper Ring
#10	909011	44" Hose Assembly With Grip
	909012	60" Hose Assembly With Grip
	909013	72" Hose Assembly With Grip
#11	990030	Pre-Rinse Spray Valve Assembly
#12	HR	Handle Ring (Not Shown)
#13	PK	Parts Kit (Not Shown)



909106B



702014B



805002B

1/4 Turn Full On



805012B

Add-On Faucet

- Heavy-duty design and engineering
- Brass construction and polished chrome body
- Double O-Ring swivel spout
- 3/8" NPT MALE inlet and FEMALE outlet

Model No.	Spout Size (inches)	Wt. lbs.
909106B	6	2
909108B	8	2
909110B	10	2
909112B	12	2
909114B	14	2
909116B	16	2

Chinese Range Faucet

- Heavy-duty design and engineering
- Brass construction and polished chrome body
- Heavy-duty Double O-Ring swivel spout
- 1/2" NPS and NPT MALE inlet
- Chrome plated brass flange

Model No.	Spout Size (inches)	Wt. lbs.
702006B	6	2
702008B	8	2
702010B	10	2
702012B	12	2
702014B	14	2
702016B	16	2

8" Heavy-Duty Wall Mount Faucet

- Integral spring check valves to prevent cross-flow of Hot and Cold water
- Brass construction and polished chrome body
- Heavy-duty double O-Ring swivel spout
- Colour coded Red and Blue handles
- 1/2" NPT Female inlets

Model No.	Spout Size (inches)	Wt. lbs.
805001B	3 1/2" Gooseneck	4
805002B	5" Gooseneck	4
805003B	8 1/2" Gooseneck	4
805006B	6	4
805008B	8	4
805010B	10	6
805012B	12	6
805014B	14	6
805016B	16	6

8" Commercial Duty Wall Mount Faucet

- Reinforced Double O-Ring Valves with Hot and Cold marked stems
- Brass construction and polished chrome body
- Heavy-duty double O-Ring swivel spout
- Colour coded Red and Blue handles
- ½" NPT FEMALE inlets

Model No.	Spout Size (inches)	Wt. lbs.
807001B	3½" Gooseneck	3
807002B	5" Gooseneck	3
807003B	8½" Gooseneck	3
807006B	6	3
807008B	8	3
807010B	10	3
807012B	12	3
807014B	14	3
807016B	16	3



807002B

**Commercial Duty
8" Lever Handle
Faucets**



807012B

4" Backsplash Wall Mount Faucet

- Reinforced Double O-Ring Valves with Hot and Cold marked stems
- High commercial quality designed for hand sinks
- Brass construction and polished chrome body
- Heavy-duty double O-Ring swivel spout
- Colour coded Red and Blue handles
- ½" NPT MALE inlets



406301B

**Heavy Duty 4"
Lever Handle
Faucets**

**1/4 Turn
Full On**



406306B

Knob Handle Model No.	Lever Handle Model No.	Spout Size (inches)	Weight lbs.
406101A	406301B	3½" Gooseneck	2/4
406102A	406302B	5" Gooseneck	2/4
406103A	406303B	8½" Gooseneck	2/4
406106A	406306B	6	2/4
406108A	406308B	8	2/4
406110A	406310B	10	3/6
406112A	406312B	12	3/6
406114A	406314B	14	3/6
406116A	406316B	16	3/6



406101A

**4" Knob Handle
Faucets**



406106A



808001B

1/4 Turn Full On



808012B

8" Heavy-Duty Deck Mount Faucet

- Integral spring check valves to prevent cross-flow of Hot and Cold water
- Brass construction and polished chrome body
- Heavy-duty double O-Ring swivel spout
- Colour coded Red and Blue handles
- 1/2" NPT FEMALE inlets

Model No.	Spout Size (inches)	Wt. lbs.
808001B	3 1/2" Gooseneck	4
808002B	5" Gooseneck	4
808003B	8 1/2" Gooseneck	4
808006B	6	4
808008B	8	4
808010B	10	6
808012B	12	6
808014B	14	6
808016B	16	6



408001B



408012B

4" Heavy-Duty Deck Mount Faucet

- Integral spring check valves to prevent cross-flow of Hot and Cold water
- Brass construction and polished chrome body
- Heavy-duty double O-Ring swivel spout
- Colour coded Red and Blue handles
- 1/2" NPT FEMALE inlets

Model No.	Spout Size (inches)	Wt. lbs.
408001B	3 1/2" Gooseneck	4
408002B	5" Gooseneck	4
408003B	8 1/2" Gooseneck	4
408006B	6	4
408008B	8	4
408010B	10	6
408012B	12	6
408014B	14	6
408016B	16	6

Single Deck Faucet with Temperature Mixing Valve

- Heavy-duty brass construction and polished chrome body
- Heavy-duty double O-Ring swivel spout

Temperature Mixing Valve

Description: Temperature Mixing Valve allows faucet water temperature to be pre-set and can be installed on any deck mount single inlet faucet or pre-rinse unit and includes:

- Built-in adjustable flow controls
- Built-in ball checks
- ½" FEMALE NPT Outlet
- Universal ¼" NPT or ½" NPS MALE Inlet

Model No.	Spout Size (inches)	Wt. lbs.
101201B	3½" Gooseneck	4
101202B	5" Gooseneck	4
101203B	8½" Gooseneck	4
101206B	6	4
101208B	8	4
101210B	10	6
101212B	12	6
101214B	14	6
101216B	16	6
909020	Temperature Mixing Valve	2



Automatic Electronic Deck Mount Mixing Faucet

- Heavy-duty brass construction and polished chrome body
- Sealed waterproof construction
- Reliable solid state electronic circuitry

Valve features the following:

- Built-in adjustable flow controls
- An infrared sensor detects the presence of an object in front of the unit and turns water On and Off
- Universal ¼" NPT or ½" NPS MALE inlets

Model No.	Spout Size (inches)	Wt. lbs.
100201	3½" Gooseneck	10
100202	5" Gooseneck	10
100206	6	10



Specifications	
Power	Four DC AA Alkaline Batteries or AC/DC Alternately
Working Pressure	0.2 - 15kg/cm2
Ambient Temp. Range	2 - 90° Celsius
Sensing Distance	2 - 17 cm (default 17cm)
Sensing Range Set-Up	Digital
Response Time	0.3 - 0.6 seconds (default 0.3 seconds)
Off Delay Time	1 - 2 seconds ((default 1 second)
Fresh Battery Life Cycle	500,000 On/Off
Low Battery Indicator	Red LED Flash
Battery Weakness	Red LED on, CPU off

Plumbing Fixtures Waste Units

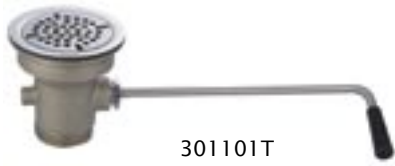

301101T



302101T



303101T

Twist Handle Waste

- Heavy-duty nickel plated bronze body construction
- Stainless steel strainer, handle and 4 3/8" diameter flange
- Stainless steel 4 3/8" diameter flange
- Drain outlet 1 1/2" NPS - Overflow outlet 1/4"

Model No.	Description	Sink Opening inches	Drain Outlet inches	Wt. lbs.
301101T	Twist Handle Waste	3.5	1.5	2
302101T	Twist Handle Waste with Overflow Outlet	3.5	1.5	2
303101T	Twist Handle Waste with Overflow Assembly	3.5	1.5	2

Overflow Head

Model No.	Description	Wt. lbs.
300010	Nickel Plated Brass body, stainless face plate - Fits 1 1/4" O. D. Tubing	2



300010

Overflow Tube

Model No.	Spout Size (inches)	Wt. lbs.
309100	7" Long Brass Overflow Tube for 1" Sink Opening	2
309101	9" Long Brass Overflow Tube for 1" Sink Opening	2
309200	7 1/2" Long Brass Overflow Tube for 1 1/2" Sink Opening	2
309201	10" Long Brass Overflow Tube for 1 1/2" Sink Opening	2
309203	12" Long Brass Overflow Tube for 1 1/2" Sink Opening	2



309203



309101

Universal Nozzles

SINGLE SPOUTS

- Double O-Ring, swivel spout
- Brass Base, polished chrome finish
- ½" NPS MALE inlet
- Compression nut and washer attached

Model No.	Spout Size inches	Description	Weight lbs.
703101	3.5	Gooseneck spout	2
703102	5	Gooseneck spout	2
703103	8.5	Gooseneck spout	2
703106	6	Straight spout	2
703108	8	Straight spout	2
703110	10	Straight spout	2
703112	12	Straight spout	2
703114	14	Straight spout	2
703116	16	Straight spout	2



703103



703114

DOUBLE JOINTED SPOUTS

- Heavy-Duty Double O-Ring, swivel spout
- Six inch joint

Model No.	Spout Size inches	Description	Weight lbs.
2001CP01	3.5	Gooseneck spout	3
2001CP02	5	Gooseneck spout	3
2001CP03	8.5	Gooseneck spout	3
2001CP06	6	Straight spout length 6"	3
2001CP08	8	Straight spout length 8"	3
2001CP10	10	Straight spout length 10"	3
2001CP12	12	Straight spout length 12"	3
2001CP14	14	Straight spout length 14"	3
2001CP16	16	Straight spout length 16"	3
2001CP18	18	Spout length 18" (6" joint+12" spout)	3



2001CP18



550



551



560



561

Shanks

Model No.	Size & Finish	Outlet size (inches)	Inlet size inches	Wt. lbs.
550	Heavy-duty polished chrome finish, brass round shank	1 1/32 - 14 UNS FEMALE outlet	1/2 - NPS MALE	2
551	Heavy-duty polished chrome finish, brass - 2 7/8" long hex shank with adjustable forged brass hex flange nut attached	1/8 NPT FEMALE outlet on hex shank and 1 1/32 - 14 UNS FEMALE outlet	1/2 - NPS MALE	2
560	Heavy-duty polished chrome finish, brass round shank with adjustable forged brass hex flange nut attached	1 1/32 - 14 UNS FEMALE outlet	1/2 - NPS MALE	2
561	Heavy-duty polished chrome finish, brass - 2 7/8" long hex shank with adjustable forged brass hex flange nut attached	1/8 NPT FEMALE outlet on hex shank and 1 1/32 - 14 UNS FEMALE outlet	1/2 - NPS MALE	2

Plumbing Fixtures Accessories



304003

304004

304004-P

304003-P

Sink Drains

Model No.	Size & Finish	Face Flange Dia. (inches)	Length inches	Weight lbs.
304003	1" NPS - Brass Finish	2	1.5	2
304004	1" NPS - Brass Finish	2	3.25	2
304004-P	1" NPS - Chrome Plated	2	3.25	2
304003-P	1" NPS - Chrome Plated	2	1.5	2

*Locknut and washer attached



Overflow Tubes
see page 30

309001

309002

309004

300000

309007

303005

Stainless Steel Drain Baskets

Model No.	Description	Sink Opening inches	NPS Outlet inches	Weight lbs.
309001	Duo-Basket Strainer w/chrome plated post, rolled edge basket & rubber seal	3.5	1.5	2
309002	Mini-Basket Strainer w/chrome plated post, rolled edge basket & rubber seal	1 7/8	1.5	2
309007	3½" Replacement basket strainer w/chrome plated post, rubber seal	Fits all standard drains		2
300000	Drain assembly for use with Overflow Tube	1.75	1.5	2
309004	Clamp basket Strainer w/two brass nuts and 4.5" face diameter w/2 zinc nuts	3.5	1.5	2
990020 not shown	Atmospheric Vacuum Breaker maintains high water flow with minimum pressure loss. Has high heat resistance and Temperature capability of up to 210 °F (99°C)			2
303005	Heavy-duty nickel plated brass Drain Outlet Reducer Bushing, with 2" FEMALE NPT and 1.5" MALE NPT			2



203100



203200



203400C



203000



203300



203500H



500



501



308001

Miscellaneous

Model No.	Description	Inlet Size inches	Outlet Size inches
203000	Double Foot Pedal, heavy-duty brass construction and rough chrome plated body, self-closing valves, reinforced Double O-Ring valves, and extra long and wide stainless steel pedals for easy operation	(2) ½ MALE NPS	(1) 3/8 FEMALE NPT
203100	Double Knee Pedal, heavy-duty brass construction and rough chrome plated body, self closing valves, reinforced Double O-Ring valves, and extra long and wide stainless steel pedals for easy operation	(2) ½ MALE NPS	(1) 3/8 FEMALE NPT
203200	Double Foot Pedal with rough chrome plated body, self-closing valves, Blue (cold) and Red (hot) indexed, polished chrome finish brass pedals	(2) ½ FEMALE NPT	(1) ½ FEMALE NPT
203300	Double Knee Pedal with rough chrome plated body, self-closing valves, Blue (cold) and Red (hot) indexed, polished chrome finish brass pedals	(2) ½ FEMALE NPT	(1) ½ FEMALE NPT
203400C	Single Foot Pedal with rough chrome plated body, self-closing valve, Blue (cold) or Red (hot) indexed, polished chrome finish brass pedal	½ FEMALE NPT	½ FEMALE NPT
203400H			
203500C	Single Knee Pedal with rough chrome plated body, self-closing valve, Blue (cold) or Red (hot) indexed, polished chrome finish brass pedal	½ FEMALE NPT	½ FEMALE NPT
203500H			
500	Standard Beverage Dispensing Faucet with heavy-duty forged brass body, polished chrome finish	1 1/32 - 14UNS MALE	N/A
501	Mini Beverage Dispensing Faucet with heavy-duty forged brass body, polished chrome finish	1 1/32 - 14UNS MALE	N/A
308001	Commercial Liquid Soap Dispenser with plastic globe, chrome finish spout and gravity type flow	Overall size: 6 1/2L x 3 7/8 W x 5 3/16 D Liquid soap capacity - 16 oz.	