

Pre-Rinse Parts

PRERINSE UNITS Feature:

- Quality engineering, design and craftsmanship
- Heavy Duty brass and forged brass body construction
- Chrome polished finish

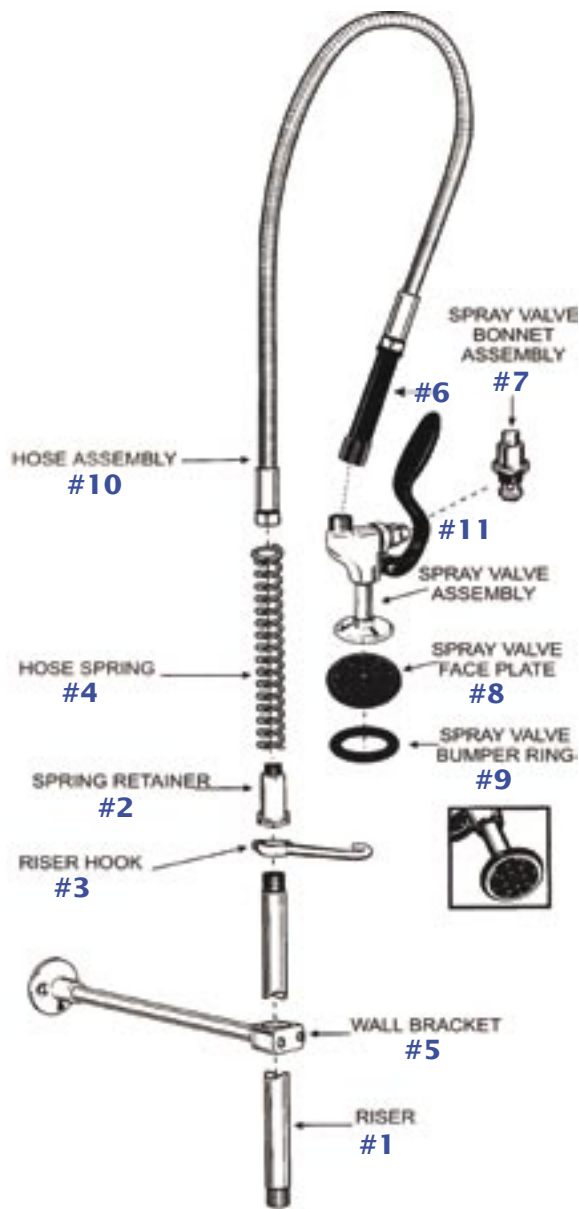

HOSE Features:

- 3-Ply, 400 PSI Test Hose
- 210° F/99° C rated
- Stainless steel outer jacket
- Stainless steel collars for added durability



	Model No.	Description
#1	909001	24" Riser
#2	909002	Spring Retainer
#3	909003	Riser Hook
#4	909004	Hose Spring
#5	909005	12" Wall Bracket
#6	909006	Hose Grip
#7	909007	Spray Valve Bonnet Assembly
#8	909008P	Plastic Spray Valve Face Plate
	909008	Brass Spray Valve Face Plate
#9	909009S	Small-Spray Valve Bumper Ring
	909009B	Big-Spray Valve Bumper Ring
#10	909011	44" Hose Assembly With Grip
	909012	60" Hose Assembly With Grip
	909013	72" Hose Assembly With Grip
#11	990030	Pre-Rinse Spray Valve Assembly
#12	HR	Handle Ring (Not Shown)
#13	PK	Parts Kit (Not Shown)